





IMPORTANT NOTE:

Read this manual carefully before installing or operating your new air conditioning unit. Make sure to save this manual for future reference.

User account

In order to use EWPE Smart app you have to create an account. When you open this application, it will guide you to sign up (to create a new account) or sign in (if you already have an account). You can also use account from older application „Wifi smart“.

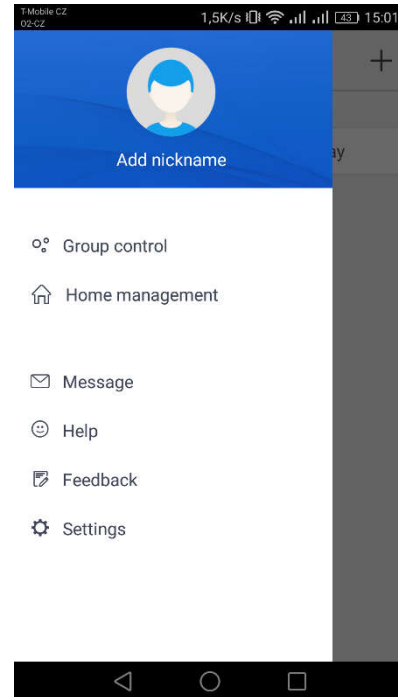
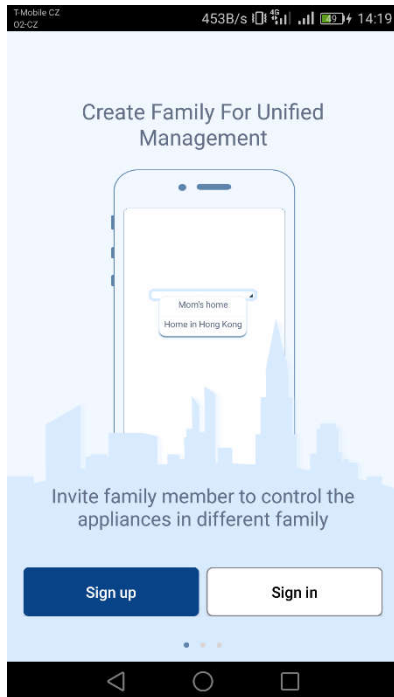

Adding an unit

It's recommended to restart Wi-Fi module before every pairing of the unit (step by step guide for restart of Wi-Fi module is at the end of this document). We also recommend to do the pairing when your mobile phone is disconnected from the Wi-Fi. Turn the Wi-Fi on only when it's necessary i.e. when you're filling in login information to particular Wi-Fi network (always connect to the right Wi-Fi network) or when the application tells you to.

More complex guide is available in the application, in the „Help“ section, tutorial is available even while pairing. Application is only available in English language.

1. Press the „+“ button in the right upper corner.

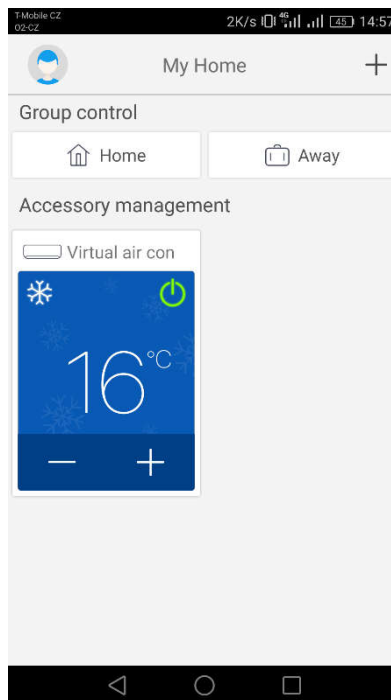

2. Choose the option „AC“ or „ATW HP“

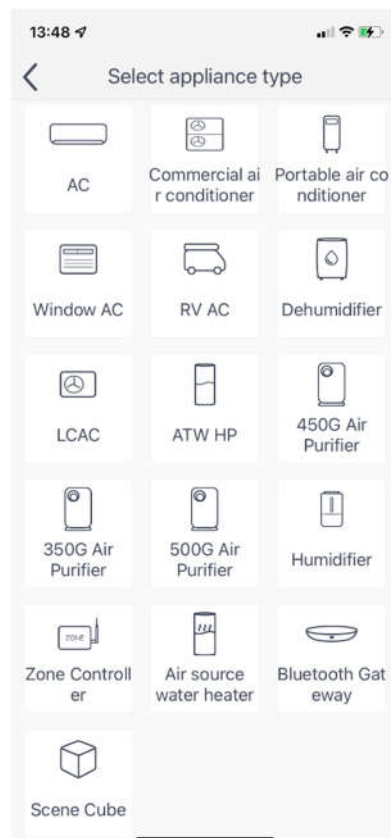

3. If you have a remote controller with the „Wifi“ button, then choose the first option („remote controller with WiFi button“). If you don't, choose the other option („Remote controller without WiFi button“). Last option („Touch control panel“) is for wired controller.

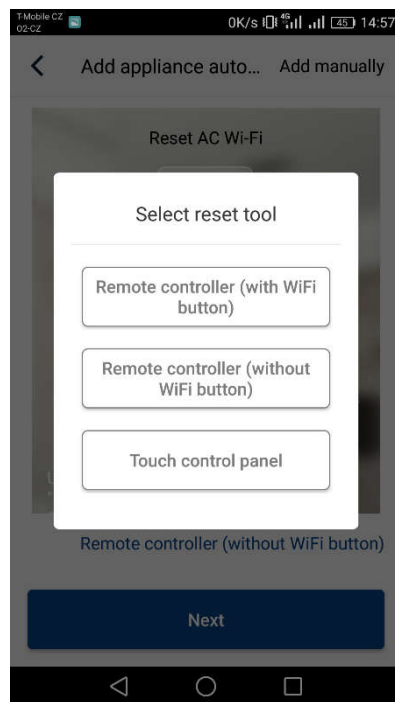

4. For Android OS: Select WiFi hotspot of the unit. Its name should correspond to the MAC address of WiFi module (you can find this information on the cover of Wi-Fi module in the unit, it is combination of letters and numbers), the password is „12345678“. After filling in all required information, press „Next“.

For iOS: Select WiFi network that you want to connect to. Fill in password and continue by pressing „Submit“

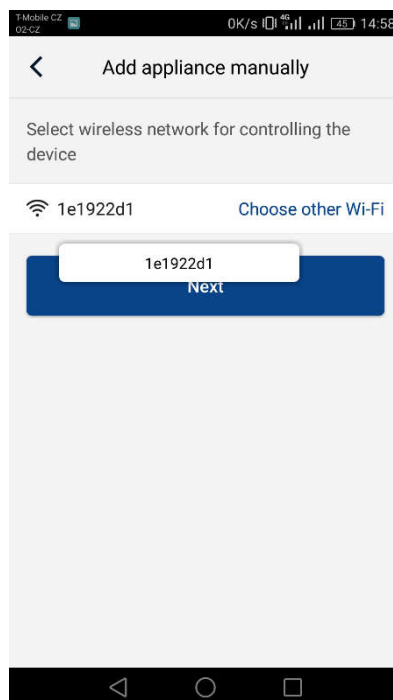

5. For Android OS: In the following step select Wi-Fi network that you want to connect to. Fill in password and continue by pressing „Submit“.

For iOS: Select WiFi hotspot of the unit. Its name should correspond to the MAC address of WiFi module (you can find this information on the cover of Wi-Fi module in the unit, it is combination of letters and numbers), the password is „12345678“. After filling in all required information, press „Next“.

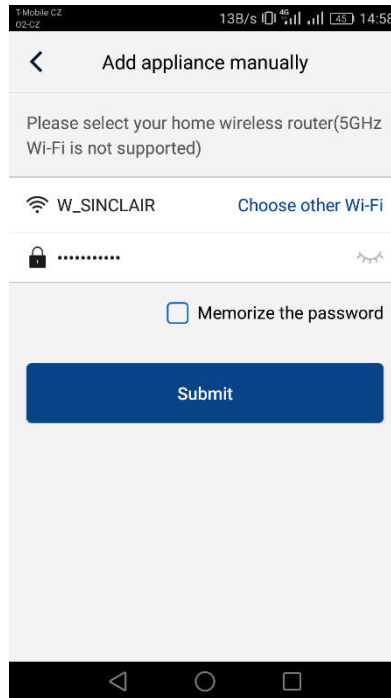

6. This picture shows the process of pairing. Please wait.

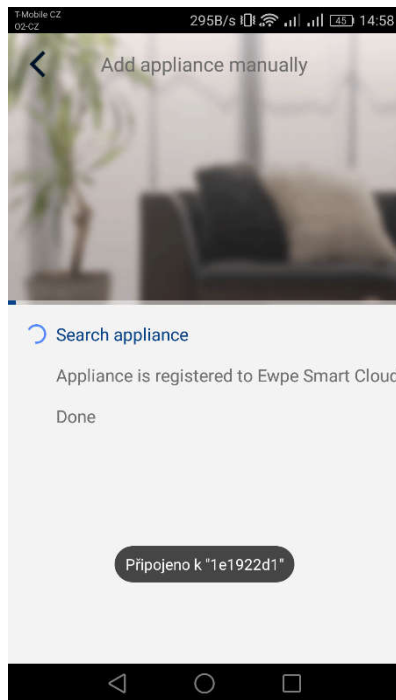

If the pairing is successful, following notice will show. Press „OK“ and it's done, now you can control the unit. We recommend you to restart „EWPE Smart“ now.

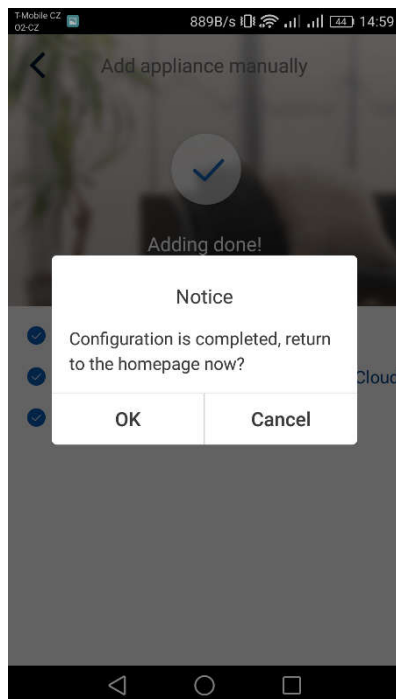

Multiple mobile phones control one AC unit:

If you want to control one AC unit with multiple mobile phones, it's possible to use function „Family control“. Firstly, you have to create a new group and then invite members by their email or nickname. More info is in the section „Group control“.

Restarting your Wi-Fi module:

1. AC unit with the „WIFI“ button remote controller

- By pressing „WiFi“ button for 3 seconds you can turn the Wi-Fi function for remote controller on or off using your smartphone or tablet.

- By pressing „WIFI“ and „MODE“ simultaneously you can restart the Wi-Fi module in the stand-by. This kind of restart will erase all settings of the Wi-Fi module and you have to pair with your smartphone again.

2. AC unit without the „WIFI“ button remote controller

-By pressing „TURBO“ and „MODE“ simultaneously you can turn the Wi-Fi function on or off.

- Restart of the Wi-Fi module is only possible in stand-by, by pressing „TURBO“ and „MODE“ simultaneously for at least 10 seconds, until the unit beeps for the second time (first beep signals turning the Wi-Fi module on or off). This kind of restart will erase all settings of the Wi-Fi module and you have to pair it with your smartphone again.

3. Heat pump SMH-xxIRB, GSH-xxIRB

In group „FUNCTION“ on the last page you select „Reset WiFi“ and confirm



If the long-range control doesn't work:

If the pairing went right and you can control AC unit while connected to your home Wi-Fi network, but you're unable to do so from another (mobile or Wi-Fi) network, then it's possible that your Wi-Fi router is blocking communication to the server. In this case we recommend you to open every single communication port on your router for IP address 138.91.51.153. Your provider of internet connection should help you with this problem.

PRODUCER

Producer: SINCLAIR CORPORATION Ltd., 1-4 Argyll St., London W1F 7LD, UK, www.sinclair-eu.com
This product was manufactured in China (Made in China).

REPRESENTATIVE AND TECHNICAL SUPPORT

Sinclair Global Group spol. s r.o.
Purkyňova 45
612 00 Brno
Czech Republic

Tel.: +420 800 100 285

www.sinclair.cz/en



NOTE CONCERNING PROTECTION OF ENVIRONMENT



This product must not be disposed of via normal household waste after its service life, but must be taken to a collection station for the recycling of electrical and electronic devices. The symbol on the product, the operating instructions or the packaging indicate such disposal procedures. The materials are recyclable in accordance with their respective symbols. By means of re-use, material recycling or any other form of recycling old appliances you are making an important contribution to the protection of our environment. Please ask your local council where your nearest disposal station is located.

INFORMATION CONCERNING USED REFRIGERANT MEDIUM

This unit is containing fluorinated gases included in the Kyoto protocol.
The maintenance and the liquidation must be carried out by qualified personnel.

Type of refrigerant: R32

The quantity of the refrigerant: Please see the unit label.

The value GWP: 675 (1 kg R32 = 0,675 t CO₂ eq)

GWP = Global Warming Potential



Appliance filled with flammable gas R32.

In case of quality problem or other please contact your local supplier or authorized service center.

Emergency number: 112

PRODUCER

SINCLAIR CORPORATION Ltd.
16 Great Queen Street
WC2B 5AH London
United Kingdom
www.sinclair-world.com

This product was manufactured in China (Made in China).

REPRESENTATIVE

SINCLAIR Global Group s.r.o.
Purkynova 45
612 00 Brno
Czech Republic

TECHNICAL SUPPORT

SINCLAIR Global Group s.r.o.
Purkynova 45
612 00 Brno
Czech Republic
Tel.: +420 800 100 285 | Fax: +420 541 590 124
www.sinclair-solutions.com | info@sinclair-solutions.com



