

Installation guide

# Thermostat

## KP 61 – KP 85

060R9758

060R9758

**KP 61, KP 62, KP 63, KP 68, KP 69** vapour charge  
**KP 62, KP 71, KP 73, KP 75, KP 77, KP 78, KP 79, KP 81, KP 85** adsorption charge (cross ambient)

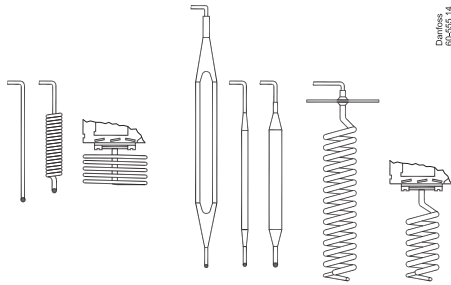
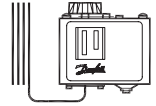

**Vapour charge    Adsorption charge**

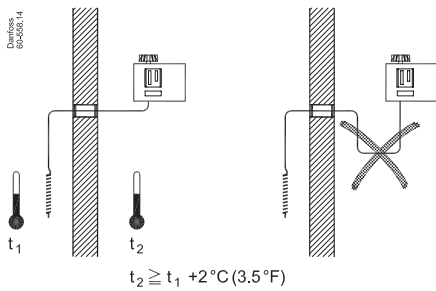
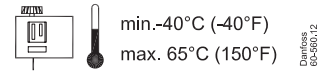
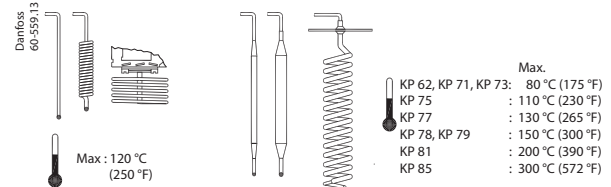

**Vapour charge**

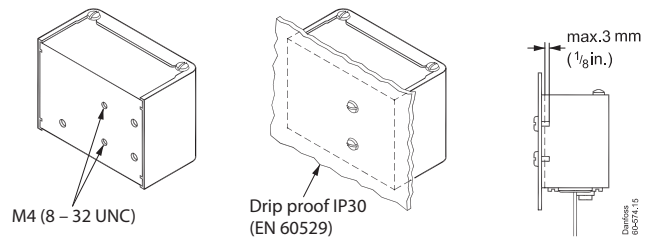
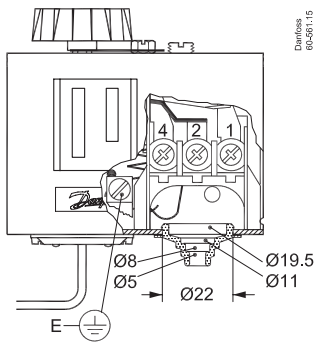
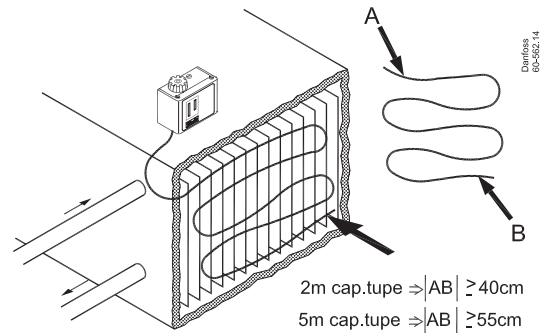

**Electrical rating - General**

|         |             |       |       |
|---------|-------------|-------|-------|
| LR 112A | AC 1: 16A   | 400 V | DC 11 |
|         | AC 3: 16A   |       | 12 W  |
|         | AC 15: 10 A |       | 220 V |

**When used acc. to UL regulations**

**UL US LISTED Listed refrigeration controller 61B5**

| Voltage | FL  | LR | Resist. load | Pilot duty |
|---------|-----|----|--------------|------------|
| AC DC   | A   | A  |              |            |
| 240     | 8   | 48 | 8 A          | 3 A        |
| 120     | 16  | 96 | 16 A         |            |
|         | 240 |    |              | 12 W       |

Use copper wire only  
 Tightening torque 20 lb.in.

\* not applying for KP 85

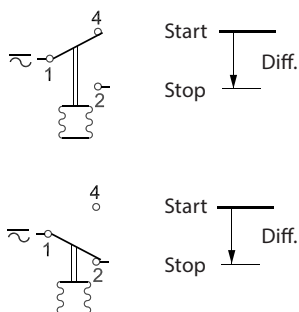



**CAUTION:**

Disconnect power supply before wiring connections are made or service to avoid possible electrical shock or damage to equipment.

Do never touch live parts with your fingers or with any tool.

**Manual trip function**

Automatic reset

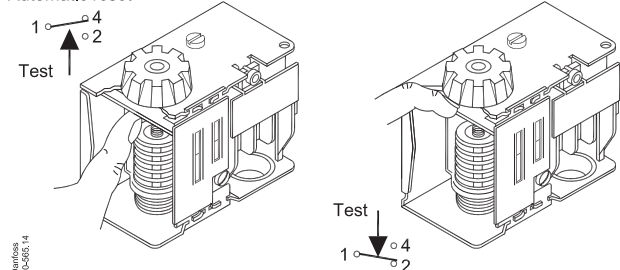

Danfoss  
60-433.14

Manual reset

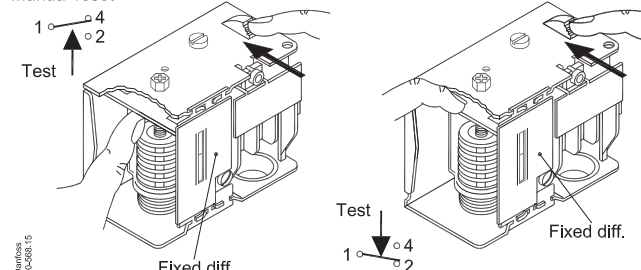

Danfoss  
60-285.15

|              |                        |
|--------------|------------------------|
| <b>KP 61</b> | 060L110466, 060L110566 |
| <b>KP 71</b> | 060L111566             |
| <b>KP 73</b> | 060L113866             |

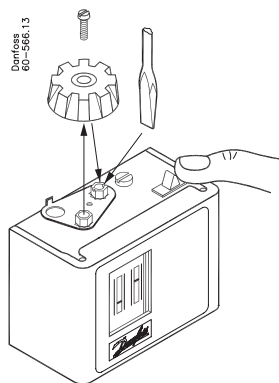

Danfoss  
60-566.13

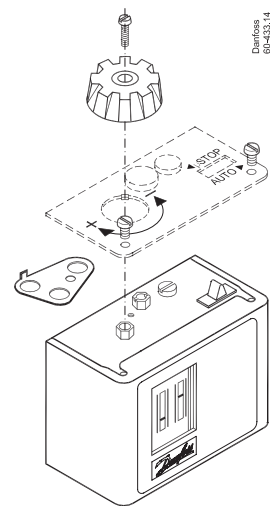

Danfoss  
60-433.14

**Vapour charge**

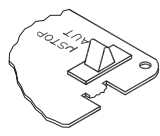
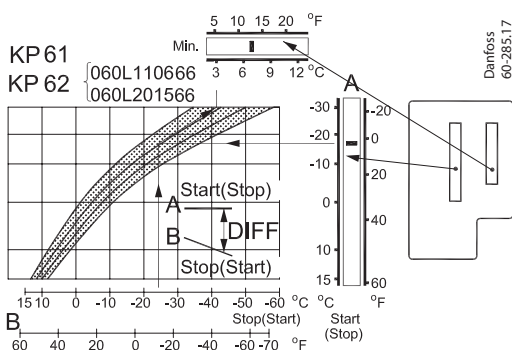

|              |                          |                   |
|--------------|--------------------------|-------------------|
| <b>KP 61</b> | 060L110366<br>060L112866 | Vapour charge     |
| <b>KP 62</b> | 060L111066               | Adsorption charge |
| <b>KP 73</b> | 060L111866               | charge            |

